

# **Region One Education Service Center Commodity Processing Forum 2025 Hosted by CNP-South Texas Cooperative**

## **LOCATION**

Region One ESC - Conference Center  
Rooms: Starr & Brooks County  
1900 W. Schunior  
Edinburg, Texas 78541  
[www.esc1.net](http://www.esc1.net)

Join us at the CNP-STC Commodity Processing Forum! This event will feature manufacturers presenting approved commodity-processed items while providing an opportunity for attendees to enjoy food tastings.

## **SCHEDULE**

**Wednesday, October 1 & Thursday, October 2**

**8:00 - 8:30 AM** - Welcome Breakfast

**8:30 - 12:00 PM** - 20 minute Vendor Presentations with food tastings

**12:00 - 12:30 PM** - Light Lunch

**12:30 - 4:00 PM** - 20 minute Vendor Presentations with food tastings

*Note: Times subject to change*

## Registration

There are no registration fees, but all participants must pre-register online at [Workshop #327236](#). **Registration will be for both Wednesday & Thursday.** Breakfast and light lunch will be provided.

## Reminders:

- No students will be in attendance during this event
- No commercial food, equipment, or janitorial items will be shown
- Event will be hosted at the Region One Education Service Center

## Hotel & Other Information

TownePlace Suites by Marriott McAllen Edinburg:  
502 W Trenton Rd. Edinburg, TX 78539  
*\*Room Block available by calling 956-318-1000*

## Region One Conference Center Map

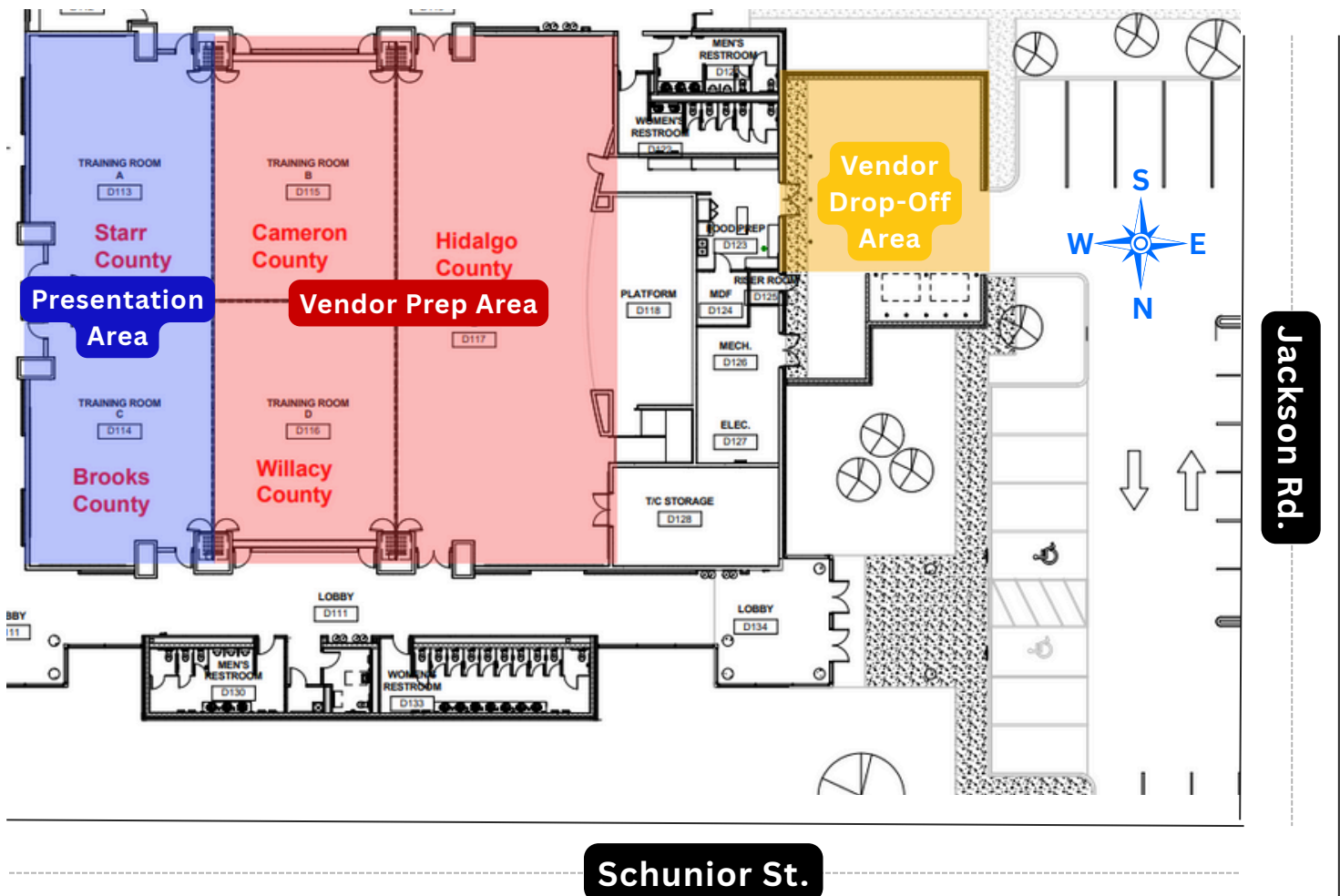

# Child Nutrition Program - South Texas Cooperative Commodity Processing Forum Processor Presentation Schedule

Time	Processor
8:30 AM - 8:50 AM	Rich Products
8:50 AM - 9:10 AM	Tyson Foods
9:10 AM - 9:30 AM	Kraft Heinz
9:30 AM - 9:50 AM	Foster Farms
9:50 AM - 10:10 AM	Michael Foods
10:20 AM - 10:40 AM	J&J Snack Foods
10:40 AM - 11:00 AM	McCain Foods
11:00 AM - 11:20 AM	International Food Solutions
11:20 AM - 11:40 AM	High Liner Foods
11:40 AM - 12:00 PM	National Food Group
12:30 PM - 12:50 PM	Schwan's
12:50 PM - 1:10 PM	Red Gold
1:10 PM - 1:30 PM	J.M. Smucker
1:30 PM - 1:50 PM	Alpha Foods
2:00 PM - 2:20 PM	Buena Vista
2:20 PM - 2:40 PM	M..C.I. Los Cabos
2:40 PM - 3:00 PM	ES Foods
3:00 PM - 3:20 PM	Jennie-O/Hormel
3:20 PM - 3:40 PM	Basic American Foods
3:40 PM - 4:00 PM	Cavendish Farms

# Child Nutrition Program - South Texas Cooperative Commodity Processing Forum

## Processor Presentation Schedule

Time	Processor
8:30 AM - 8:50 AM	Integrated Food Service
8:50 AM - 9:10 AM	Del Real Foods
9:10 AM - 9:30 AM	Yang's 5 <sup>th</sup> Taste
9:30 AM - 9:50 AM	Rich Chick's
9:50 AM - 10:10 AM	S.A. Piazza/Wild Mike's
10:20 AM - 10:40 AM	Gold Creek Foods
10:40 AM - 11:00 AM	Don Lee Farms
11:00 AM - 11:20 AM	Brookwood Farms
11:20 AM - 11:40 AM	Bake Crafters
11:40 AM - 12:00 PM	Idahoan Foods
12:30 PM - 12:50 PM	Tasty Brands
12:50 PM - 1:10 PM	Tabatchnick Fine Foods
1:10 PM - 1:30 PM	Bongard Cheese
1:30 PM - 1:50 PM	JTM Foods
2:00 PM - 2:20 PM	Nardone Brothers Pizza
2:20 PM - 2:40 PM	Wawona Frozen Foods
2:40 PM - 3:00 PM	ProView
3:00 PM - 3:20 PM	Chef's Corner
3:20 PM - 3:40 PM	Rodriguez Foods

Thursday, October 2, 2025